

Partial Wall Framing Systems

# Technical Note

Analysis and Design of MidWall™  
(Base Connector in Partial Wall Systems)

By: Paul Lackey, P.E.  
Muhammad Ghoraba  
Nabil A. Rahman, Ph.D., P.E.  
Kurtis Kennedy, P.E.



The Steel Network, Inc.  
2012-A T.W. Alexander Drive  
P.O. Box 13887  
Durham, NC 27709  
Phone: (888)474-4876  
[www.steelnetwork.com](http://www.steelnetwork.com)

Updated October 2021

# ANALYSIS AND DESIGN OF MOMENT RESISTING MIDWALL™ BY THE STEEL NETWORK, INC.

**Paul Lackey, P.E., Muhammad Ghoraba, Nabil A. Rahman, Ph.D., P.E.,  
and Kurtis Kennedy, P.E.**

MidWall™ is a hold-down product intended to simplify and optimize the design and construction of a short wall or half wall in residential and commercial cold formed steel framing. Available in widths of 2-1/2", 3-5/8" and 6", and lengths of 24" or 48", MidWall™ is a one piece connection/framing unit which offers optimization of material and streamlines installation. The assembly consists of MidWall™ members spaced along the length of the wall with a top track spanning between MidWall™ members. The top track acts as a load distribution member capable of distributing localized loads to multiple MidWall™ members as shown in Figure 1. MidWall™ may be used as a cost effective solution to several common construction conditions including interior half walls, strip window framing, and parapet framing. The information provided within this technical note is intended to describe the design criteria regulated by the building code for several MidWall™ uses and give a summary of the analysis and design procedure to these criteria. This analysis procedure is also implemented in the SteelSmart® System cold formed steel analysis and design software (SSS Version 8).

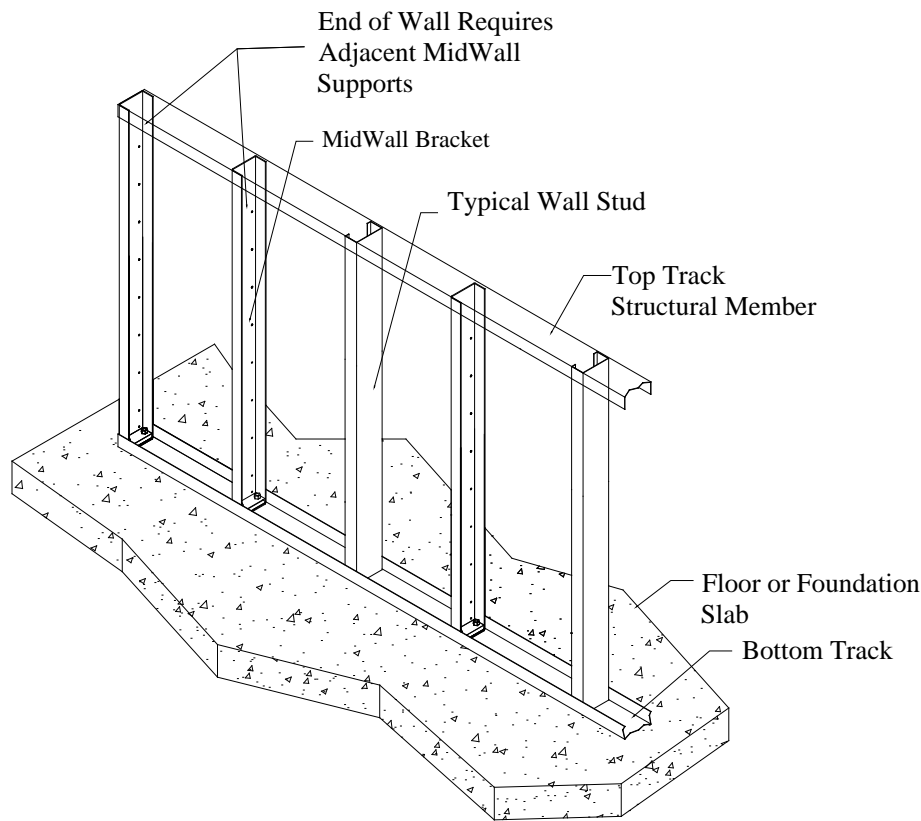

**Figure 1: MidWall™ Assembly**

## FULL SCALE TESTS

The strength and behavior of the MidWall™ framing component were determined through a series of full scale tests performed on both the 24” and the 48” long sections for each MidWall™ member width. Tests were performed on single sections, with a concentrated out of plane point load applied 48” above the floor attachment. A 1-5/8” flange, 54 mil (16 gauge) stud was used in conjunction with the 24” long MidWall™ member. Applied load and corresponding out of plane displacement were recorded throughout the tests. Figure 2 shows a sample load displacement curve for the 6” wide, 48” long MidWall™ (600MW-48) product. Factors of safety for allowable loads were calculated per Section K2 of AISI S100-16 North American Specification for the Design of Cold-Formed Steel Structural Members. Table 1 provides the maximum allowable load for each MidWall™ width. For detailed information on test setup, procedure, and results, refer to the respective MidWall™ test report by The Steel Network, Inc.

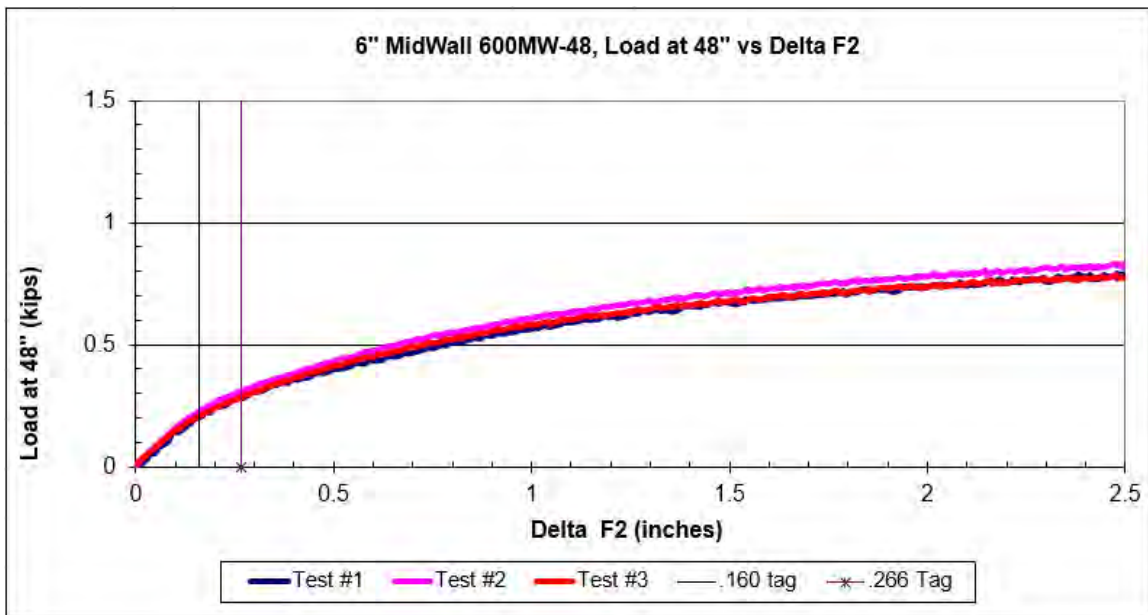

**Figure 2: Load Displacement Curve for 6” MidWall™ 48” (600MW-48)**

**Table 1: MidWall™ Allowable Loads**

Wall Width (in.)	MidWall™ Member	Maximum Allowable Load @ 48” (ASD), lbs	Maximum Base Moment, lbs-in.
2-1/2	250MW	128	6,150
3-5/8	362MW	332	15,940
6	600MW	407	19,540

The testing of the MidWall™ members yielded deflections higher than those calculated from structural mechanics of cantilever beams due to rotation occurring in the connection of the MidWall™ to the support structure. An analytical method has been used to determine the magnitude of the deflection caused by the base rotation by subtracting the theoretical deflection from the actual tested deflection. The base rotation can then be

associated with a specific base moment which can be used in other loading scenarios with the theoretical deflection to determine the overall deflection. Figure 3 gives the base rotation associated with the base moment determined using the described method for each of the MidWall™ products. A curve is fit to the data points to provide a simple formula for the base rotation corresponding to any base moment. Note that uppercase "E" in the formula is the scientific notation for "10 to the power of".

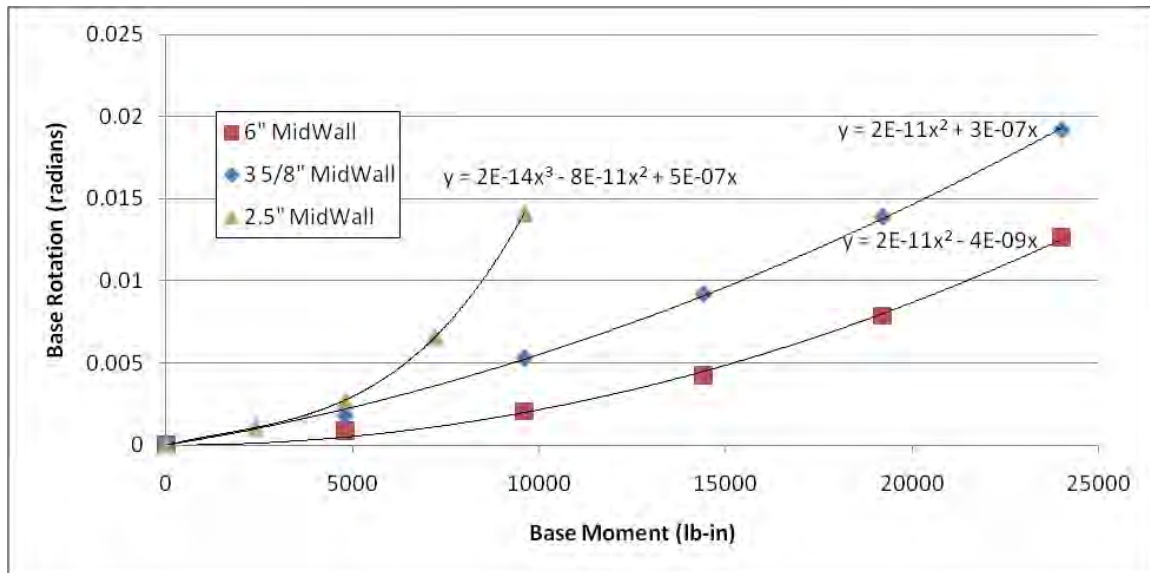

**Figure 3: Base Rotation vs. Base Moment Curve for Each MidWall™ Type**

## DESIGN CRITERIA

The MidWall™ product provides an optimal design solution to several common framing applications in commercial and residential framing including interior half wall framing, parapet framing, and strip window framing. The loading criterion for each of these conditions is described within this section. In addition to satisfying the strength requirements of the loading criteria, the member must also satisfy common serviceability limitations determined either by the building code or industry practice. Table 2 provides typical deflection requirements for different framing applications.

**Table 2: Serviceability Requirements of MidWall™ Applications**

Code	Use	Deflection Limits <sup>1</sup>
2018 / 2015 / 2012 / 2009 IBC	Exterior walls and interior partitions with brittle finishes	L/240
2018 / 2015 / 2012 / 2009 IBC	Exterior walls and interior partition with flexible finishes	L/120
2018 / 2015 / 2012 / 2009 IBC	Interior walls and partitions	H/180
Brick Industry Association	Exterior walls backing brick veneer	L/600

<sup>1</sup> For cantilever members, L and H are taken as twice the length of the cantilever

## Interior Half Wall Framing Criteria for Guard or Handrail Applications

An interior half wall is common in commercial and residential construction. In some applications the half wall is required to resist occupants from falling from an elevated surface or provide a handrail for climbing or stability assistance. The MidWall™ product meets the performance requirements for this application.

### **Commercial Framing Design Criteria**

The design criteria of an interior short wall for use as a “guard” are described within the 2018/2015/2012/2009 International Building Code (IBC):

*2018/2015/2012 IBC Section 1607.8.1 (2009 IBC Section 1607.7.1)*

*Handrails and guards shall be designed to resist a load of 50 plf in accordance with Section 4.5.1.1 of ASCE 7. (Handrails and guards shall be designed to resist a load of 50 plf applied in any direction at the top and to transfer this load through the supports to the structure.)*

*2018/2015/2012 IBC Section 1608.7.1.1 Concentrated Load (2009 IBC Section 1607.7.1.1 Concentrated Load)*

*Handrails and guards shall be designed to resist a concentrated load of 200 pounds in accordance with Section 4.5.1.1 of ASCE 7. (Handrails and guards shall be able to resist a single concentrated load of 200 pounds, applied in any direction at any point along the top, and to transfer this load through the supports to the structure. This load need not be assumed to act concurrently with the loads specified in the Section 1607.7.1.)*

### **Residential Framing Design Criteria**

The design criteria of an interior short wall for usage as a guardrail or handrail are described within the 2018/2015/2012/2009 International Residential Code (IRC):

*Table R301.5 Minimum Uniformly Distributed Live Loads*

<i>Use</i>	<i>Live Load</i>
<i>Guardrails and handrails<sup>d</sup></i>	<i>200</i>
<i>Guardrails in-fill components<sup>f</sup></i>	<i>50</i>

*d. A single concentrated load applied in any direction at any point along the top.*

*f. Guard in-fill components (all those except the handrail), balusters and panel fillers shall be designed to withstand a horizontally applied normal load of 50 pounds on an area equal to 1 square foot. This load need not be assumed to act concurrently with any other live load requirement.*

## Interior Half Wall Framing for Walls greater than 6 feet in height

The design criterion for tall interior cantilever wall framing is not explicitly defined in the IBC, but these walls exist in both commercial and residential construction in various

applications. For this type of framing, a combination of design criteria for guards and interior walls greater than 6' in height can be used. The criterion for use as a guard or handrail, as described in the previous section, is considered at a 48" height.

### **Commercial Framing Design Criteria**

The design criterion for interior walls and partitions greater than 6' in height is described within the 2018/2015/2012/2009 IBC:

*2018 IBC Section 1607.15 / 2015/2012 IBC Section 1607.14 (2009 IBC Section 1607.7.13)*

*Interior walls and partitions that exceed 6 feet in height, including their finish materials, shall have adequate strength to resist the loads to which they are subjected but not less than a horizontal load of 5 psf.*

### **Parapet Framing**

A parapet extends above the roof level for aesthetic purposes and provides a cover to hide utilities which may be present on the roof of a commercial building. In many framing applications a parapet must cantilever out from the roof level as opposed to bypassing the roof level. The MidWall™ product is capable of satisfying the load requirements for this application.

### **Commercial Framing Design Criteria**

The loading criteria for a parapet is determined using the appropriate zone combinations of the component and cladding wind load as determined by Chapter 16 of the 2018/2015/2012/2009 IBC. Additionally, snow drift or 'guard' load requirements should be considered as applicable. Zone combinations for the component and cladding wind loads to be used on the parapet are described in ASCE 7-16, 7-10, and 7-05:

*ASCE 7-16 Section 30.8 / ASCE 7-10 Section 30.9 (ASCE 7-05 Section 6.5.12.4.4)  
Two load cases, see Fig. 30.8-1 / Fig. 30.9-1, shall be considered: Load Case A: Windward parapet shall consist of applying the applicable positive wall pressure from Fig. 30.3-1 / Fig. 30.4-1 or Fig. 30.5-1 / Fig. 30.6-1 to the windward surface of the parapet while applying the applicable negative edge or corner zone roof pressure from Figs. 30.3-2 / Figs. 30.4-2 through 30.3-7 / 30.4-7, Fig. 27.3-3 / Fig. 27.4-3 footnote 4, or Fig. 30.5-1 / Fig. 30.6-1 as applicable to the leeward surface of the parapet. Load Case B: Leeward parapet shall consist of applying the applicable positive wall pressure from Fig. 30.3-1 / Fig. 30.4-1 or Fig. 30.5-1 / Fig. 30.6-1 to the windward surface of the parapet, and applying the applicable negative wall pressure from Fig. 30.3-1 / Fig. 30.4-1 or Fig. 30.5-1 / Fig. 30.6-1 as applicable to the leeward surface. Edge and corner zones shall be arranged as shown in the applicable figures. ( $GC_p$ ) shall be determined for appropriate roof angle and effective wind area from applicable figures. If internal pressure is present, both load cases should be evaluated under positive and negative internal pressure. (Two load cases shall be considered. Load Case A shall consist of applying the applicable positive wall pressure from Fig. 6-11A or Fig. 6-17 to the front surface of the parapet while applying the applicable negative edge or corner zone roof pressure from Figs. 6-11 through 6-17 to the back surface. Load Case B shall consist of applying the applicable positive wall pressure from Fig. 6-11A or Fig. 6-1 to the back of*

parapet surface, and applying the applicable negative wall pressure from Fig. 6-11A or Fig. 6-17 to the front surface. Edge and corner zones shall be arranged as shown in Figs. 6-11 through 6-17.  $GC_p$  shall be determined for appropriate roof angle and effective wind area from Figs. 6-11 through 6-17. If internal pressure is present, both load cases should be evaluated under positive and negative internal pressure.)

### Strip Window Framing

A strip window is a window with a high width to height ratio and one that requires intermediate support of the header and sill between jamb members. In this application, a MidWall™ may be used at intermediate points along the length of the window to support the header and sill as shown in Figure 4.

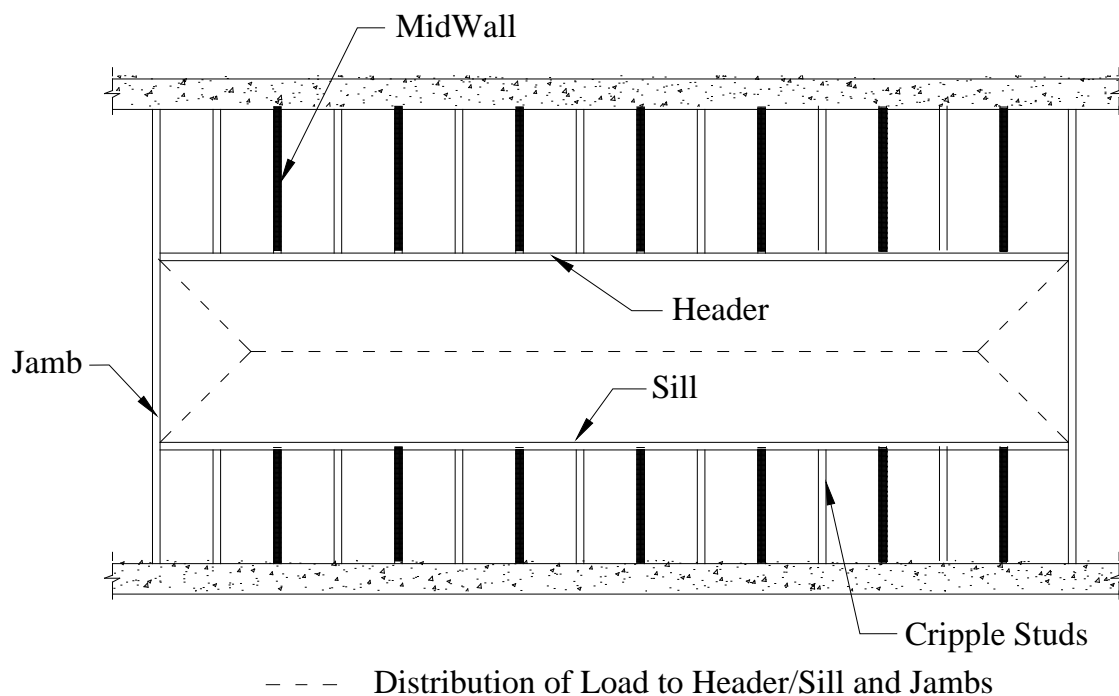

**Figure 4: MidWall™ in Strip Window Application**

### **Commercial Framing Design Criteria**

The loading criteria for a strip window is determined using the wind load determination procedures outlined in Section 1609 of the 2018/2015/2012/2009 IBC in conjunction with ASCE 7-16, 7-10, or 7-05.

### **Residential Framing Design Criteria**

The loading criteria for a strip window is determined using the appropriate zone of the component and cladding wind pressure along with the exposure adjustment factor as determined by Tables R301.2(2) and R301.2(3) of the 2018/2015/2012/2009 IRC.



## ANALYSIS PROCEDURE

Analysis and design of the MidWall™ product for the intended application is completed using a multi-step process consisting of 3-D frame analysis, member strength and serviceability checks, and anchorage design. To determine the distribution of localized loads to multiple MidWall™ members, a 3-D frame analysis is required. The model for analysis consists of MidWall™ members fixed at the base and spaced at intervals within the wall, with a top track spanning between members as illustrated in Figure 5. Appropriate material and section properties are assigned to each framing member. A summary of MidWall™ properties can be found in Table 3. MidWall™ members are considered as prismatic and assigned the properties of the MidWall™ member, ignoring the contribution of any attached stud sections. The formation of the stiffness matrix with respect to the MidWall™ member consists of the theoretical stiffness only. The loading criteria required by the building code are applied to the model to determine the loading and reactions at each MidWall™.

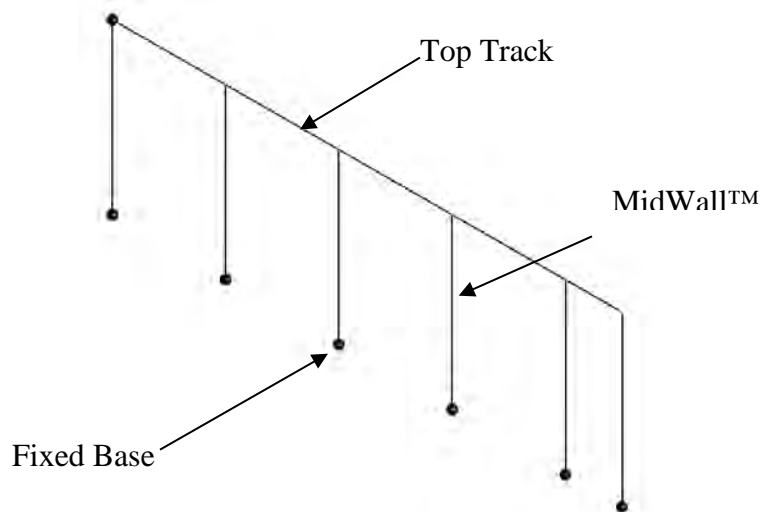

**Figure 5: Illustration of Assembly Model**

**Table 3: Material and Section Properties**

Section	Properties (E = 29,500 ksi)
250MW	$I_x = 0.757 \text{ in.}^4$
362MW	$I_x = 1.948 \text{ in.}^4$
600MW	$I_x = 5.271 \text{ in.}^4$

The strength of the member can be determined as adequate provided that the actual base moment is less than the allowable base moment given in Table 1. To determine the deflection at the end of the MidWall™ member, the theoretical deflection obtained from the frame analysis is added to the deflection contributed by the base rotation. The base rotation is determined using the base moment with the appropriate formula from Figure 3.



The base rotation can then be used with the length of the member to determine the end deflection contribution from base rotation.

## MIDWALL™ ANCHORAGE

### Anchorage Design

The MidWall™ anchorage functions as a fixed connection with both shear force and bending moment acting on the connection. A 2-1/2" wide MidWall™ accommodates a single 1/2" anchor. Both the 3-5/8" and 6" wide MidWall™ accommodate (2) 3/8" anchors. Two methods are available for analysis and design of the anchorage of MidWall™: simplified analysis and design with a conservative anchor force approximation or modeling of the anchorage in standard industry wide anchorage design software. For the simplified design method the applied moment can be resolved into an anchor tension force for the MW250 (single anchor), and an anchor tension force for one of the anchors into the supporting structure for the MW362/600. The tension load in the double anchor anchorage can be determined assuming the bearing stress distribution shown in the Figure 6. This assumed stress distribution provides a conservative anchor force approximation.

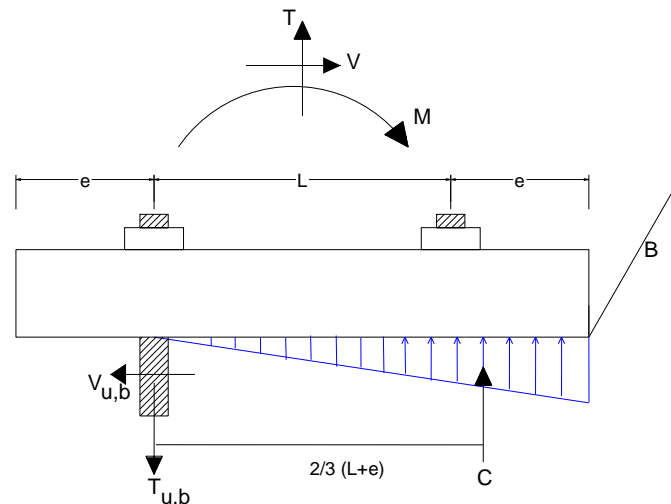

**Figure 6: Stress Distribution on 362/600 MidWall™ Connection to Foundation**

- B = bearing width, in.
- C = compressive force on concrete, kips
- e = edge distance of bolt, in.
- N = number of bolts in the connection
- L = distance between bolts, in. (= 0 in case of one bolt)
- M = applied moment on connection, kips-in.
- T = applied tension force on connection, kips

$V$  = applied shear force on connection, kips

$T_{u,b}$  = actual tensile force on one bolt, kips

$$= \frac{M}{\frac{2}{3}(L + e)} + \frac{T}{N}$$

$V_{u,b}$  = actual shear force on one bolt, kips

$$= \frac{V}{N}$$

$\phi T_n$  = LRFD tensile strength of the bolt from manufacturer's technical literature, kips

$\phi V_n$  = LRFD shear strength of the bolt from manufacturer's technical literature, kips

Check the anchorage of the MidWall™ connection per ACI 318-14, Section 17.6:

- $T_{u,b} \leq \phi T_n$
- $V_{u,b} \leq \phi V_n$
- Interaction

A trilinear interaction approach is presented in ACI318-14, which accounts for the tension and/or shear utilization of the steel anchors and concrete material. The traditional expression includes the 5/3 exponents for the tension ratio and the shear ratio, which ACI references as part of the trilinear interaction verification.

Allowable shear capacity for double anchors should consider a reduction in shear capacity relative to spacing between anchors as suggested by the anchors' manufacturer. Tension capacity of the anchorage is not required to be reduced since only one anchor is assumed to be in tension at any given time. Both shear and tension capacities should consider reduction relative to edge distance of foundation or slab if this condition exists.

The alternative to the simplified approach is to model the anchors and the anchorage conditions in industry standard anchor design software. With this method, the designer can set other criteria which would influence the anchorage design, permitting for the most efficient design to be specified. Tables 4 and 5 present a non-inclusive list of anchorage options for a variety of factored tension loads associated with both 3/8" and 1/2" anchors, respectively. The tables assume a maximum factored shear load on a single anchor of 100 lbs for the load interaction check and no limits on edge distance for shear and tension. For consideration of edge distances, it is recommended to utilize available industry standard anchorage design software.

**Table 4: 362/600 MidWall™ 3/8” Anchor Options**

Max Applied Tension on One Anchor (lbs) (LRFD)	Anchor Options (4,000 psi min. normal weight cracked concrete strength) (LRFD)
1,800	3/8” Screw-Bolt+, 3-1/4” Nominal Embedment (Dewalt) 3/8” Kwik Bolt TZ2-CS, 3” Nominal Embedment (Hilti)
2,200	3/8” Screw-Bolt+, 3-1/4” Nominal Embedment (Dewalt) 3/8” Kwik Bolt TZ2-CS, 3” Nominal Embedment (Hilti)
2,400	3/8” HAS-E Threaded Rod w/ HIT-HY 200 Epoxy, 3” Eff. Embed. (Hilti)
3,200	3/8” HAS-E Threaded Rod w/ HIT-HY 200 Epoxy, 4” Eff. Embed. (Hilti)

**Table 5: 250 MidWall™ 1/2” Anchor Options**

Max Applied Tension on One Anchor (lbs)	Anchor Options (4,000 psi min. normal weight cracked concrete strength)
900	1/2” Screw-Bolt+, 2-1/2” Nominal Embedment (Dewalt) 1/2” Kwik HUS-EZ, 2-1/4” Nominal Embedment (Hilti)
1,200	1/2” Screw-Bolt+, 2-1/2” Nominal Embedment (Dewalt) 1/2” Kwik HUS-EZ, 2-1/4” Nominal Embedment (Hilti)
1,600	1/2” Screw-Bolt+, 3” Nominal Embedment (Dewalt) 1/2” Kwik HUS-EZ, 3” Nominal Embedment (Hilti)

**DESIGN EXAMPLE (1)**

Scenario: 4’-0” interior partition with MidWall™ support @ 48” o.c.  
Serviceability Limit: H/180  
Design Load: 5 psf  
Wall Width: 3-5/8”  
Anchor Type: (2) 3/8” HAS-E Threaded Rod w/ Hilti HIT-HY 200 Epoxy, 2-3/8” Effective Embedment  
Concrete: 4000 psi Cracked Normal Weight  
Design Method: ASD (Member) / LRFD (Anchorage)

Step 1) 3-D frame analysis not required for this design condition since load is uniform across wall surface.

Step 2) Check Strength of Member:

- Uniform load along length of MidWall™ member = (5 psf) \* (4’) = 20 lbs/ft
- Moment at base = (20 lb/ft) \* (4’)² / 2 = 160 lbs-ft = 1,920 lbs-in

- From Table 1, maximum base moment = 15,940 lbs-in, Strength is OK

### Step 3) Check Serviceability of Member:

- Uniform load along length of member = 20 lbs/ft = 1.67 lbs/in
- Length of member = 4'-0" = 48"
- Theoretical deflection =  $(1.67 \text{ lb/in}) * (48'')^4 / (8) * (29,500,000 \text{ ksi}) * (1.984 \text{ in}^4) = 0.019''$
- Base rotation (y) to base moment (x) from figure 3:  $y = 2(10)^{-11} x^2 + 3(10)^{-7} x$
- At base moment of 1,920 lbs-in: Base rotation = 0.00065 radians
- Deflection at tip due to rotation =  $48 \tan (0.00065) = 0.031''$
- Total deflection =  $0.019'' + 0.031'' = 0.05''$
- Allowable deflection =  $(48'') * (2) / 180 = 0.53''$ , Serviceability is OK

### Step 4) Design of Anchorage:

Factored lateral loads for input into anchor design software (Hilti Profis):

- Applied moment ( $M_u$ ) =  $1.6 * 1,920 \text{ lbs-in} = 3,072 \text{ lbs-in}$
- Applied shear ( $V_u$ ) =  $1.6 * (5 \text{ psf}) * (4') * (4') = 128 \text{ lbs}$
- Design Assumptions:
  1. Unlimited edge distance
  2. 4" Slab depth

### 3/8" HAS-E Threaded Rod w/ Hilti HIT-HY 200 Epoxy, 2 3/8" Effective Embedment:

Tension:

- Steel Strength (Single Anchor):  $\phi N_{\text{Steel}} = 3,653 \text{ lbs} > N_u = 1,211 \text{ lbs}$ , OK
- Bond Strength (Anchor Group):  $\phi N_{\text{Bond}} = 1,992 \text{ lbs} > N_u = 1,211 \text{ lbs}$ , OK
- Concrete Breakout Failure (Anchor Group):  $\phi N_{\text{Breakout}} = 2,558 \text{ lbs} > N_u = 1,211 \text{ lbs}$ , OK

Shear:

- Steel Strength (Single Anchor):  $\phi N_{\text{Steel}} = 2,022 \text{ lbs} > N_u = 64 \text{ lbs}$ , OK
- Pryout Strength (Anchor Group):  $\phi N_{\text{Pryout}} = 2,558 \text{ lbs} > N_u = 128 \text{ lbs}$ , OK

Interaction

- $(0.608)^{5/3} + (0.050)^{5/3} = 0.443 < 1.0$ , OK

## **DESIGN EXAMPLE (2)**

Scenario: 3'-0" high parapet with MidWall™ @ 24" o.c., Brick Veneer  
Wind Load: 67 psf  
Wall Width: 6"  
Anchor Type: (2) 3/8" HAS-E Threaded Rods w/ Hilti HIT-RE 500 Epoxy, 4-3/4" Effective Embedment  
Concrete: 4000 psi Cracked Normal Weight  
Design Method: ASD (Member) / LRFD (Anchorage)

Step 1) 3-D frame analysis not required for this design condition since load is uniform across wall surface.

Step 2) Check Strength of Member:

- Uniform load along length of MidWall™ member =  $0.6 * (67 \text{ psf}) * (2') = 80 \text{ lbs/ft}$
- Moment at base =  $(80 \text{ lb/ft}) * (3')^2 / 2 = 360 \text{ lbs-ft} = 4,320 \text{ lbs-in}$
- From Table 1, maximum base moment = 19,540 lbs-in, Strength is OK

Step 3) Check Serviceability of Member:

- Uniform load along length of member =  $80 \text{ lbs/ft} = 6.67 \text{ lbs/in}$
- Length of member =  $3'-0" = 36"$
- Theoretical deflection =  $(6.67 \text{ lb/in}) * (36")^4 / (8) * (29,500,000 \text{ psi}) * (5.271 \text{ in}^4) = 0.009"$
- Base rotation (y) to base moment (x) from figure 3:  $y = 2(10)^{-11} x^2 - 4(10)^{-9} x$
- At base moment of 4,320 lbs-in: Base rotation = 0.0004 radians
- Deflection at tip due to rotation =  $36" * \tan(0.0004) = 0.014"$
- Total deflection =  $0.009" + 0.014" = 0.023"$
- Allowable deflection =  $(36") * (2) / 600 = 0.12"$ , Serviceability is OK

Step 4) Design of Anchorage:

Factored lateral loads for input into anchor design software (Hilti Profis):

- Applied moment ( $M_u$ ) =  $4,320 \text{ lbs-in} / 0.6 = 7,200 \text{ lbs-in}$
- Applied shear ( $V_u$ ) =  $(67 \text{ psf}) * (3') * (2') = 402 \text{ lbs}$
- Design Assumptions:
  1. 1-13/16" Edge Distance
  2. 6" Slab depth

3/8" HAS-E Threaded Rod w/ Hilti HIT-RE 500 Epoxy, 4 3/4" Effective Embedment:

Tension:

- Steel Strength (Single Anchor):  $\phi N_{\text{Steel}} = 3,653 \text{ lbs} > N_u = 1,788 \text{ lbs}$ , OK
- Bond Strength (Anchor Group):  $\phi N_{\text{Bond}} = 2,988 \text{ lbs} > N_u = 2,130 \text{ lbs}$ , OK
- Concrete Breakout Failure (Anchor Group):  $\phi N_{\text{Breakout}} = 3,999 \text{ lbs} > N_u = 2,130 \text{ lbs}$ , OK

Shear:

- Steel Strength (Single Anchor):  $\phi N_{\text{Steel}} = 2,022 \text{ lbs} > N_u = 201 \text{ lbs}$ , OK
- Pryout Strength (Anchor Group):  $\phi N_{\text{Pryout}} = 7,314 \text{ lbs} > N_u = 402 \text{ lbs}$ , OK
- Concrete Edge Failure:  $\phi N_{\text{Edge}} = 702 \text{ lbs} > N_u = 402 \text{ lbs}$ , OK

Interaction

-  $(0.713)^{5/3} + (0.572)^{5/3} = 0.963 < 1.0$ , OK

**DESIGN EXAMPLE (3)**

- Scenario: 4'-0" Interior MidWall™ for guard application @ 30" o.c.  
Serviceability Limit: L/120  
Load: 200 lb point load in any direction or 50 lb/ft linear load along top of wall  
Wall Width: 3-5/8"  
Anchor Type: (2) 3/8" HAS-E B7 Threaded Rods w/ Hilti HIT-RE 500 Epoxy, 3-3/4" Effective Embedment  
Concrete: 4000 psi Cracked Normal Weight  
Design Method: ASD (Member) / LRFD (Anchorage)

Step 1) 3-D Frame Analysis:

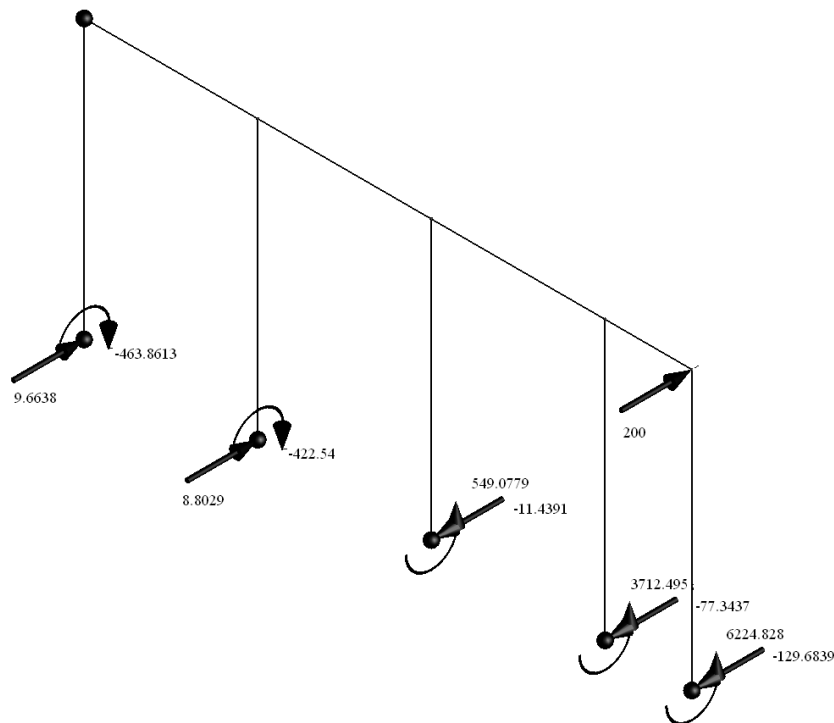

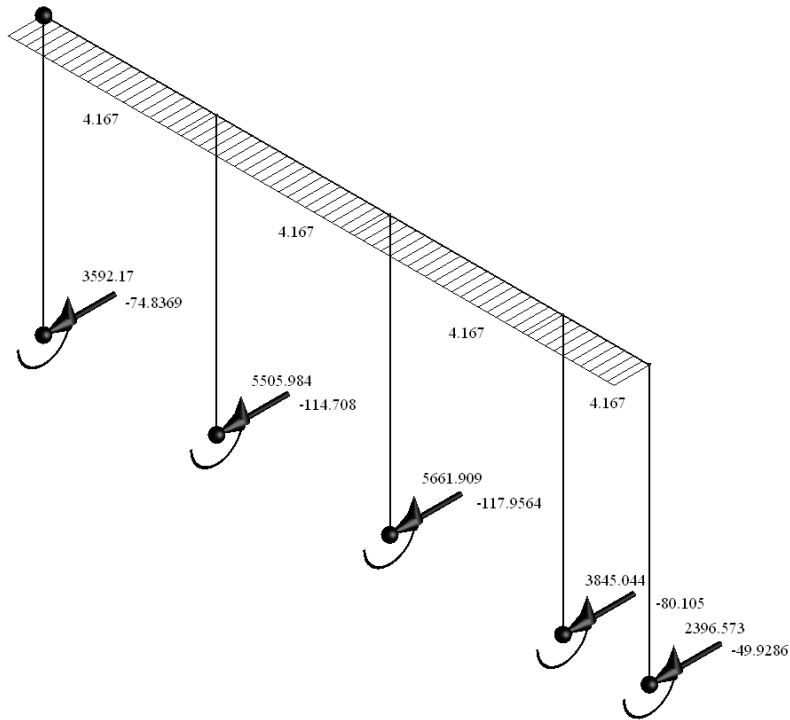

#### Step 2) Check Strength of Member:

- From analysis maximum load in MidWall™ member = 129.7 lbs
- Moment at base = (129.7 lbs) \* (4') = 519 lbs-ft = 6226 lbs-in
- From Table 1, maximum base moment = 15,940 lbs-in → Strength is OK

#### Step 3) Check Serviceability of Member:

- Length of member = 4' 0" = 48"
- Theoretical deflection = (129.7 lbs) \* (48")<sup>3</sup> / (3) \* (29,500,000 psi) \* (1.948 in<sup>4</sup>) = 0.083"
- Base rotation (y) to base moment (x) from figure 3:  $y = 2(10)^{-11} x^2 + 3(10)^{-7} x$
- At base moment of 6226 lbs-in: Base rotation = 0.00264 radians
- Deflection at tip due to rotation = 48 tan (0.00264) = 0.127"
- Total deflection = 0.083" + 0.127" = 0.21"
- Allowable deflection = (48") \* (2) / 120 = 0.80" → Serviceability is OK

#### Step 4) Design of Anchorage:

Factored lateral loads for input into anchor design software (Hilti Profis):

- Applied moment ( $M_u$ ) = 1.6 \* 6,226 lbs-in = 9,962 lbs-in
- Applied shear ( $V_u$ ) = 1.6 \* 129.7 lbs = 207.5 lbs
- Design Assumptions:
  1. Unlimited edge distance
  2. 5" Slab depth



3/8" HAS-E B7 Threaded Rod w/ Hilti HIT-RE 500 Epoxy, 3 3/4" Effective Embedment:

Tension:

- Steel Strength (Single Anchor):  $\phi N_{\text{Steel}} = 7,264 \text{ lbs} > N_u = 3,902 \text{ lbs}$ , OK
- Bond Strength (Anchor Group):  $\phi N_{\text{Bond}} = 3,944 \text{ lbs} > N_u = 3,902 \text{ lbs}$ , OK
- Concrete Breakout Failure (Anchor Group):  $\phi N_{\text{Breakout}} = 5,075 \text{ lbs} > N_u = 3,902 \text{ lbs}$ , OK

Shear:

- Steel Strength (Single Anchor):  $\phi N_{\text{Steel}} = 3,776 \text{ lbs} > N_u = 104 \text{ lbs}$ , OK
- Pryout Strength (Anchor Group):  $\phi N_{\text{Pryout}} = 10,020 \text{ lbs} > N_u = 208 \text{ lbs}$ , OK

Interaction

- $(0.989 + 0.027) / 1.2 = 0.847 < 1.0$ , OK

## CLOSING REMARKS

The use of MidWall™ in both residential and commercial framing streamlines the construction of a short wall. The International and Residential Building Codes give specific criteria for the design of several applications for which the MidWall™ may be used. The contents of this technical note provide full scale testing results, building code design requirements, and an overview of the analysis procedure for MidWall™. Steel Smart System (SSS Version 8), a cold-formed steel design software, automates this analysis procedure for quick and accurate framing options, including anchorage. For further information and download of SSS 8, visit [www.steelSMARTsystem.com](http://www.steelSMARTsystem.com). Users of the MidWall™ product will benefit from substantial cost savings associated with both material and labor.

## REFERENCES

- ACI 318-14, "Building Code Requirements for Structural Concrete and Commentary", American Concrete Institute (ACI), 2014 Edition, Michigan.
- AISI S100-16, "North American Specification for the Design of Cold-Formed Steel Structural Members", American Iron and Steel Institute (AISI), 2016 Edition, Washington, DC.
- ASI SSS8, "Steel Smart System Version 8", Cold Formed Steel Design Software, Applied Science International, LLC, Durham, NC.
- Hilti, "North American Product Technical Guide" Volume 2 Edition 21, [www.us.hilti.com](http://www.us.hilti.com).
- International Code Council (ICC). "International Building Code", ICC Standard, 2018, 2015, 2012 and 2009 Editions, Virginia.
- International Code Council (ICC). "International Residential Code", ICC Standard, 2018, 2015, 2012 and 2009 Editions, Virginia.
- Dewalt Fasteners. "Mechanical Anchors." Online, <https://anchors.dewalt.com/anchors/>.